

BASc Common Room

THE BRIEF

The requirement for a student common room for a new, high profile undergraduate BASc programme, was to provide a quality student space for both study, relaxation and interaction. For this creative course a dynamic and inspiration environment needed to be created. JPA Furniture was successful in supply all the furniture for this innovative multi-use area.



CASE STUDY



BASc Common Room

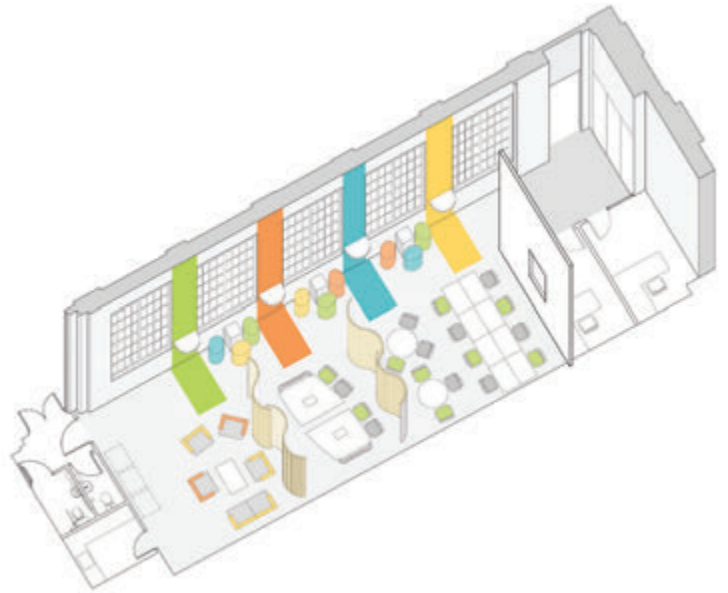

© Paul Murphy Architects



BASc Common Room

THE SOLUTION

Working closely with the architect the design provided a range of individual, group and collaborative study and social areas. Using a mixed palette of colours and graphics the space was divided up with purpose-designed joinery and a feature ceiling of slatted oak beams. A careful combination of designated breakout and touchdown areas, fixed computer spaces and a group working area allowed the furniture to compliment with texture and colour. This was combined with an interactive media wall with squiggle glass and large screens. Mobile collaborative learning tables gave focus to the writing wall which pulled all the areas together.

THE IMPLEMENTATION

A key element in making this project successful was to ensure that the installation was completed on time for the start of the new academic year. This time critical project worked smoothly with each different item, be it tables, chairs or sofas, was placed in the right position first time. JPA Furniture devised a plan and ensured that careful liaison with the designer and architect was maintained throughout the project. Carl Gombrich, Programme Director, positively commented 'what a great job the project has been and how it has set the right tone for undergraduate learning in UCL'



Printed on FSC® Mix Credit Certified Material

Photographs: Tony Harris
Architects: Paul Murphy Architects